

LAFORTE® 100 Fabric

Technical Specifications

Ph Technology	Drop on-demand Piezo inkjet technology	
Printhead	Type	2.556 nozzle - 2 colour, Water based
	Drop Size	4pl to 72pl
	Number of printheads	8pcs
Printing Width	Max.	1850mm
	Min.	100mm
Print Mode	Resolution	600x300, 600x600, 600x900, 600x1200, 900x600, 900x900, 1200x1200
	Passes	1/2/3/4/6/8 (uni and bi-directional)
	Operating temperature	20°C to 30°C (68°F to 86°F)
Environmental conditions	Humidity	From 35% to 60% RH (no condensation)
	Recommended printing environment	Temperature 22°C to 28°C (71.6°F to 82.4°F) Humidity 40%
	Recommended Storage environment	16°C to 38°C (60.8°F to 100.4°F) Store the printer filled with ink
Ink	Operating environment	Traditional place dust proof
	Tank Capacity	5kg/10Kg/20Kg
Size	4680 (W) x 1550 (D) x 2250 (H) mm	
Weight	2400 kg	
Power	Voltage	400 V ± 10%, 3 Phase + neutral + Earth, 32A
	Frequency	50-60Hz
	Power consumption	12 KW – average running consumption 6Kwh
Compressed Air	Compressed air supply	8 bar
	Air supply quality	Standard ISO 8573.1 – class 2,4,3
	Air consumption	Max. 250 L/h
Water	Water pressure	Min. 4 bar max. 5bar
	Water flow rate	50 to 100 litres per hour
Belt system	Rotary Sticky belt	
Feeding System (standard)	Max. roll size Ø	0.5mt diameter / 200Kg
	Pneumatic roll bar	2 inch standard (3 inch optional)
Feeding System (optional)	Max. roll size Ø	1.5mt diameter / 1 tons
Take Up unit (optional)	Max. roll size Ø	0.5mt diameter / 200 Kg
	Pneumatic roll bar	2 inch standard (3 inch optional)

aleph® inks

Substrate Compatibility

	Pigment	Reactive	Acid	Disperse
Nylon	○	○	●	○
Nylon Lycra	○	○	●	○
Polyester	○			●
Silk	○	○	●	
Cotton	●	●		
Polycotton	●			
Viscose/Rayon	●	●		
Linen	●	●		
Wool	○	○	●	

Ink Colour

Pigment inks	Reactive	Acid	Disperse
Black	Black	Black	Black
Cyan	Cyan	Cyan	Cyan
Magenta	Magenta	Magenta	Magenta
Yellow	Yellow	Yellow	Yellow
Orange	Orange	Orange	Orange
Green	Green	Blue	Violet
Red	Red	Light Black	Red
Violet			Grey



4 colours 2xCMYK



8 heads / 1 row / 16 colour line

Speed



2x4 colours Up to 280 sqm/h

1x8 | 1x6 colours Up to 140 sqm/h

* All the printing speeds have been calculated based on 1500mm-width printer and may vary depending on the substrates, the level of the quality and the selected print width.

Key Features

Technology Highlights	Distinctive Features
<ul style="list-style-type: none"> ✓ Superior Productivity - Up to 280 sqm/h ✓ Superior Printing Quality - Variable drop technology - Resolution up to 1200 dpi - Dynamic Stitching Technology (DST) for high-quality multi-pass printing ✓ Dual-Channel Printheads - 2 colours per printhead - Drastically reduced maintenance costs due to the smaller number of printheads - High speed and accurate jetting ✓ Pioneering Media Feeding System - Rotary sticky belt - Advancement accuracy 40 microns - Enabling more stability and eradicating elongation for superior quality ✓ Extremely low energy consumption reducing overall sustainable impact 	<ul style="list-style-type: none"> ✓ Anti-mist technology & solvent free printing - Healthy environment for the operator - No solvent and glue used on belt ✓ Ink Supply System - Automatic negative pressure control - Negative pressure control system on each ink line - Ink tanks from 5kg to 20kg per colour - Plug & Play Ink Tanks ✓ Reliable and accurate motion - Magnetic linear motor and double rail for carriage stability - Aluminum bridge 0.02 mm torsion/deflection - Safety system - preventing printheads from collision with the substrates ✓ Service - Remote System Control/Assistance - IoT Support - Easy Maintenance ✓ Workflow - Interfacing with aleph, Inedit, Ergosoft, Caldera, Onyx



Compact design and robust frame



Advanced Inkjet Printing Technology
Variable drop – from 4pl to 72pl
(2.656 nozzles – 2 colours – Resolution up to 1200 dpi)



Dual-Channel Printheads
2 colours for printhead enabling high print accuracy with smaller number of printhead



Cutting-edge Sublimation Inks
4 / 6 / 8 colours
Ink tank capacity: 5/10/20 kg/lt



Pioneering Media Feeding system
Rotary sticky belt
Advancement accuracy 40 microns



DST – Dynamic Stitching Technology for high-quality multi-pass printing



Anti-mist technology & Solvent-free printing



User-friendly Touch Panel and Ethernet 1/10 GB Interface



Low power consumption

Integrated Production Line

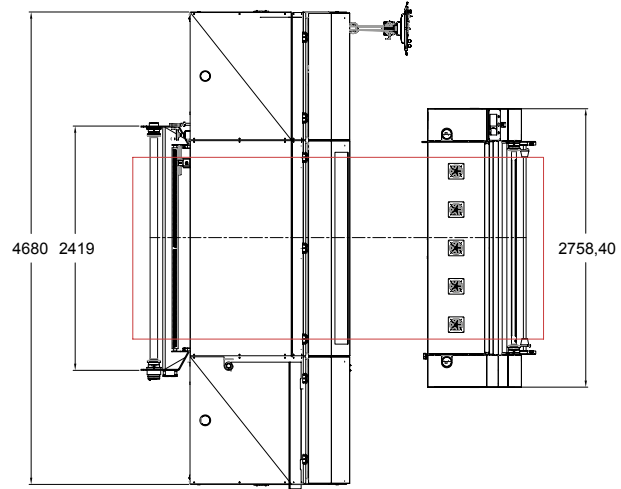
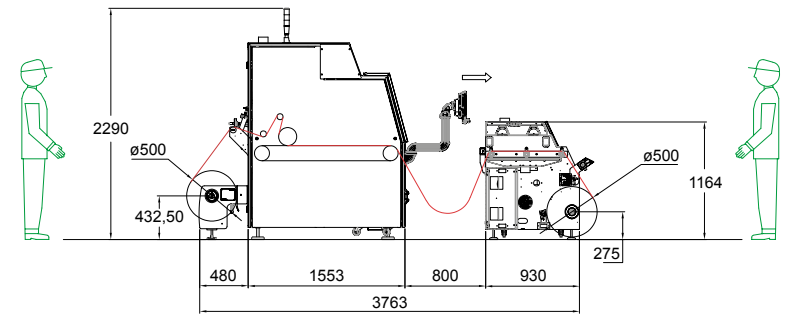

Full-line Configuration

- The setting is available for all printer models
- Accessories are available as optional

aleph Srl
Via Giotto, 26
22075 Lurate Caccivio (CO) - Italia
T. +39 031 575902
F. +39 031 3385098

www.alephteam.com
sales@alephteam.com



LAFORTE[®] 100 FABRIC

Superior Print Quality

Advanced Eco-friendly Technology

Comprehensive, Integrated Solution Enabling Top Performances

Energy-Saving Production Process



MADE IN ITALY

aleph

In printing, we care

aleph specialises in developing and manufacturing advanced direct-to-fabric and direct to paper inkjet printers for the textile and visual communication industries and provides its customers with total, integrated solutions.

Founded in 1999 and headquartered at the heart of the Italian textile district of Como, the company has grown to become one of the leading international players in the digital printing space. With a dedicated sales force and a widespread distribution network, aleph operates in key textile and out-of-home markets across the globe.

The company's extensive experience in the textile industry has enabled aleph to progressively expand the offer and boost the service, with the final goal to actively contribute to customers' success. aleph offers integrated printing solutions, featuring proprietary software, cutting-edge digital printers, as well as drying systems and consumables.

aleph's green policy focuses on environmental and social sustainability. With the company steadily focused on innovation, aleph's customers can benefit from cost-effective technologies with reduced environmental impact and designed to increase the users' green reputation.

LAFORTE Fabric[®] Series



LAFORTE 200



LAFORTE 400



LAFORTE 340



LAFORTE 600

Cost-effective Direct to Fabric Digital Printer

aleph

in printing, we care

A Durst Group Company